

MAHARASHTRA METRO RAIL CORPORATION LIMITED
NAGPUR METRO RAIL PROJECT

Date: 26-07-2024

Corrigendum-VIII

Part-A

Name of Work: Design, Supply, Installation, Testing & Commissioning of Receiving cum Auxiliary Main Cum Traction Sub Stations including EHV connection from grid substation, 33 KV Cable network, ASS & SCADA System for Nagpur Metro Rail Phase-2 Project.

Tender No: - N2-031/TR-03/2023 dated 16.02.2024

The events of submission of this tender are being re-scheduled as per table-1 below:

Table-1

SN	Event	Existing	Revised as
1	Document on sale	Documents can be downloaded from 16.00 hrs. 16.02.2024 to 16.00 Hrs. On 05.08.2024 from Maha-Metro's E-Tender Portal	Documents can be downloaded from 16.00 hrs. 16.02.2024 to 16.00 Hrs. On 09.08.2024 from Maha-Metro's E-Tender Portal
2	Date & Time of submission of tender	At 16.00 Hrs. of 05.08.2024	At 16.00 Hrs. of 09.08.2024
3	Date & Time of opening of Technical Bid	At 16:30 Hrs of 05.08.2024	At 16:30 Hrs of 09.08.2024
4	Last date of EMD/Bid security to reach to Maha-Metro	12.08.2024	16.08.2024

26/07/2024
ED/Procurement
Maha-Metro, Nagpur

NAGPUR METRO

Corrigendum-VIII

Part-B

SN	Part No.	Section	Clasue ref.	Clause																																								
1	Corrigen dum-V	Appendix-8 to Corrigendum-V Section-III: Evaluation and Qualification Criteria	2.4.1 (d)	<p>Existing Clause:</p> <table border="1"> <thead> <tr> <th>Criteria</th> <th colspan="3">Compliance Requirements</th> <th>Documents</th> </tr> <tr> <th rowspan="2">Requirement</th> <th rowspan="2">Single Entity</th> <th colspan="3">Joint Venture</th> <th rowspan="2">Submission Requirements</th> </tr> <tr> <th>All Partners Combined</th> <th>Each Partner</th> <th>One Partner</th> </tr> </thead> <tbody> <tr> <td>d) Supply, Ereclion, Testlmg and Commissioning of SCADA system for Elevated /at grade/ Underground sections of Metro Rail or Monorail or Suburban Rail or Main line Railway System</td> <td>"Must meet requirement for one contract</td> <td>N/A</td> <td>N/A</td> <td>"Must meet requirement for one contract</td> <td></td> </tr> </tbody> </table> <p>Replaced With:</p> <table border="1"> <thead> <tr> <th>Criteria</th> <th colspan="3">Compliance Requirements</th> <th>Documents</th> </tr> <tr> <th rowspan="2">Requirement</th> <th rowspan="2">Single Entity</th> <th colspan="3">Joint Venture</th> <th rowspan="2">Submission Requirements</th> </tr> <tr> <th>All Partners Combined</th> <th>Each Partner</th> <th>One Partner</th> </tr> </thead> <tbody> <tr> <td>d) Supply, Ereclion, Testlmg and Commissioning of SCADA system for Elevated /at grade/ Underground sections of Metro Rail or Monorail or Suburban Rail or Main line Railway System</td> <td>"Must meet requirement for one contract (Requirement can be met through a Specialized Subcontractor)"</td> <td>N/A</td> <td>N/A</td> <td>"Must meet requirement for one contract (Requirement can be met through a Specialized Subcontractor)"</td> <td></td> </tr> </tbody> </table>	Criteria	Compliance Requirements			Documents	Requirement	Single Entity	Joint Venture			Submission Requirements	All Partners Combined	Each Partner	One Partner	d) Supply, Ereclion, Testlmg and Commissioning of SCADA system for Elevated /at grade/ Underground sections of Metro Rail or Monorail or Suburban Rail or Main line Railway System	"Must meet requirement for one contract	N/A	N/A	"Must meet requirement for one contract		Criteria	Compliance Requirements			Documents	Requirement	Single Entity	Joint Venture			Submission Requirements	All Partners Combined	Each Partner	One Partner	d) Supply, Ereclion, Testlmg and Commissioning of SCADA system for Elevated /at grade/ Underground sections of Metro Rail or Monorail or Suburban Rail or Main line Railway System	"Must meet requirement for one contract (Requirement can be met through a Specialized Subcontractor)"	N/A	N/A	"Must meet requirement for one contract (Requirement can be met through a Specialized Subcontractor)"	
Criteria	Compliance Requirements			Documents																																								
Requirement	Single Entity	Joint Venture			Submission Requirements																																							
		All Partners Combined	Each Partner	One Partner																																								
d) Supply, Ereclion, Testlmg and Commissioning of SCADA system for Elevated /at grade/ Underground sections of Metro Rail or Monorail or Suburban Rail or Main line Railway System	"Must meet requirement for one contract	N/A	N/A	"Must meet requirement for one contract																																								
Criteria	Compliance Requirements			Documents																																								
Requirement	Single Entity	Joint Venture			Submission Requirements																																							
		All Partners Combined	Each Partner	One Partner																																								
d) Supply, Ereclion, Testlmg and Commissioning of SCADA system for Elevated /at grade/ Underground sections of Metro Rail or Monorail or Suburban Rail or Main line Railway System	"Must meet requirement for one contract (Requirement can be met through a Specialized Subcontractor)"	N/A	N/A	"Must meet requirement for one contract (Requirement can be met through a Specialized Subcontractor)"																																								
2	Part-2	Section VI-C Tender Drawings	New Attachment (Tender drawing)	The R1A1 GAD is as added as 'Appendix-1 to Corrigendum-VIII'.																																								



Handwritten signature and date:
 28/07/2024
 ED Proc

SITABULDI / KHAPRI

NORTH - SOUTH METRO CORRIDOR

METRO CITY / MIDC ESR

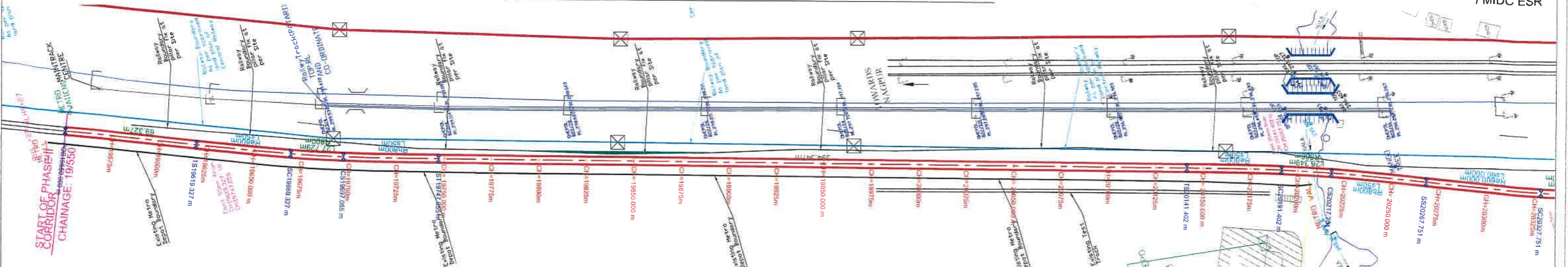

VERTICAL_ALIGN	HORIZONTAL_ALIGN	DIFF. IN ELE.	RAIL LEVELS	GROUND LEVELS	CHAINAGES
L=198.596 m G=-0.998%	SL69 327m*	1.211	300.370	300.370	19550
L=143.403 m G=-1.765%	TRL=50m	2.741	298.591	298.591	19575
L=28.243 m G=-1.600%	TRL=50m	2.799	298.283	298.283	19600
	TRL=50m	3.066	297.767	297.767	19625
	TRL=50m	3.372	297.211	297.211	19650
	TRL=50m	3.551	296.783	296.783	19675
	TRL=50m	3.053	297.031	297.031	19700
	TRL=50m	2.910	296.925	296.925	19725
	TRL=50m	2.507	297.078	297.078	19750
	TRL=50m	3.354	295.867	295.867	19775
	TRL=50m	1.844	295.935	295.935	19800
	TRL=50m	2.065	295.293	295.293	19825
	TRL=50m	2.604	295.293	295.293	19850
	TRL=50m	1.673	295.783	295.783	19875
	TRL=50m	2.035	294.978	294.978	19900
	TRL=50m	1.718	294.806	294.806	19925
	TRL=50m	2.124	294.376	294.376	19950
	TRL=50m	3.286	293.214	293.214	19975
	TRL=50m	3.418	293.082	293.082	20000
	TRL=50m	3.721	292.779	292.779	20025
	TRL=50m	4.077	292.423	292.423	20050
	TRL=50m	4.522	291.978	291.978	20075
	TRL=50m	3.420	293.080	293.080	20100
	TRL=50m	3.363	293.137	293.137	20125
	TRL=50m	4.674	291.926	291.926	20150
	TRL=50m	4.231	292.268	292.268	20175
	TRL=50m	5.323	291.177	291.177	20200
	TRL=50m	6.145	290.355	290.355	20225
	TRL=50m	6.462	290.238	290.238	20250
	TRL=50m	5.887	290.613	290.613	20275
	TRL=50m	6.095	290.485	290.485	20300

SPECIAL NOTES:

- BEFORE EXECUTION OF WORK, THE ENGINEER IN-CHARGE SHALL CHECK ALL THE LEVELS, COORDINATES, ETC.
- CHAINAGES AND LAYOUT OF STATIONS/PIERS/PLATFORMS ARE SHOWN FOR INFORMATION ONLY. FOR DETAILS, SEPARATE ARCHITECTURAL/ STRUCTURAL DRAWINGS ETC. SHALL BE REFERRED.

Notes:-

- All levels, chainages and dimensions are in meter unless otherwise mentioned.
- Station/Pier/Platform are shown for information only.
- The horizontal alignment, vertical profile, Rail Levels & DTM are based on the topographical survey & ground levels available with planning cell. Concern CPM and GC should re-validate the survey data at site and work shall be executed after correctness of survey is certified by concern CPM, GC & contractor.
- Pier Arrangement shall be planned keeping C/L of pier minimum 6m away from the SRJ.

SYMBOL		DESCRIPTION		SYMBOL		DESCRIPTION	
---	METRO ALIGNMENT	---	RAILING	---	RAILWAY BOUNDARY STONE	---	9PC STORE
---	METRO STATION BOUNDARY	---	COMPOUND WALL	---	STRUCTURE (BUILD UP)	---	TEMPLE
---	ASPHALT ROAD EDGE	---	GATE	---	STRUCTURES (TEMPORARY)	---	NALA BED LEVEL
---	MEPERN (DIVIDER)	---	BOARD/HOARDING	---	DRAIN EDGE (CONVST & NATURAL)	---	RAILWAY TOP LEVEL
---	ROAD CENTER	---	CHAMBER	---	NALLA	---	HIGH FLOOD LEVEL
---	TOE LINE	---	ELECTRIC POLE WITH LINE (L.T.)	---	CULVERT	---	BRIDGE TOP LEVEL
---	SHOULDER LINE	---	ELECTRIC OP	---	ROAD CENTER LEVEL	---	
---	RAILWAY LINE	---	TREE	---		---	
---	RAILWAY ELECTRIC POLE	---	FENCING	---		---	

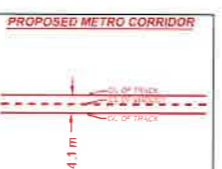

THE RESPONSIBILITY OF CONTROL, CHECK & VERIFICATION OF ACCURACY, CORRECTNESS, COMPLETENESS INTEGRATION & FULL COMPLIANCE OF CONTRACT PROVISIONS IN RESPECT OF DESIGN ANALYSIS & DRAWINGS RESTS WITH THE DESIGN CONSULTANT AND CONTRACTOR.					
Maha Metro	For GAD Approval	Signature	Maha Metro	For GAD Approval	Signature
Approved	Dy. CPM (Reach-I)		Approved	ACPM (Traction)	
	Sr. DGM (Track)			ED (Electrical)	
	ED (Reach-I & Track)			ACPM (Signalling)	
				ED (Signalling)	
				ACPM (Rolling Stock)	
				ED (Rolling Stock)	
	Sr. DGM (Planning-I)				
	ED (Planning-I & Land)			GM (O&M)	

GOOD FOR CONSTRUCTION

MAHARASHTRA METRO RAIL CORP. LTD.

METRO BHAVAN, INFRONT OF DR. BABASAHEB AMBEDKAR COLLEGE, DEEKSHABHOOMI, NAGPUR - 440010

TITLE: ALIGNMENT PLAN & VERTICAL PROFILE FOR AT-GRADE SECTION OF REACH 1A FROM TAKE-OFF POINT (CH:19550) UPTO METRO CITY STATION

HORIZONTAL SCALE: 0 10m 20m 30m 40m 50m 60m 70m 80m 90m 100m

VERTICAL SCALE: 0 5m 10m 15m 20m 25m 30m 35m 40m 45m 50m

DRG.NO. MM/PLG-I/1A/AG/AGAD/2023/R3 **REV.** 03 **PAPER SIZE** A1 **DATE** 16.01.2024 **SHEET NO.** 02 OF 03

SITABULDI / KHAPRI

NORTH - SOUTH METRO CORRIDOR

ASHOKVAN / MIDC ESR

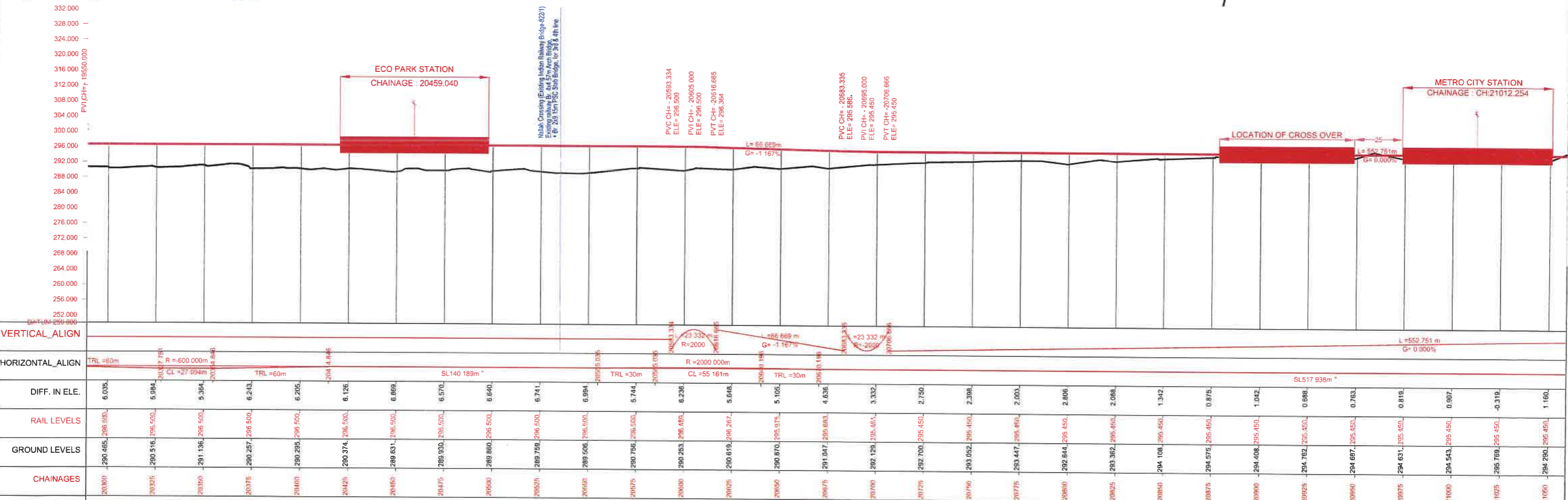
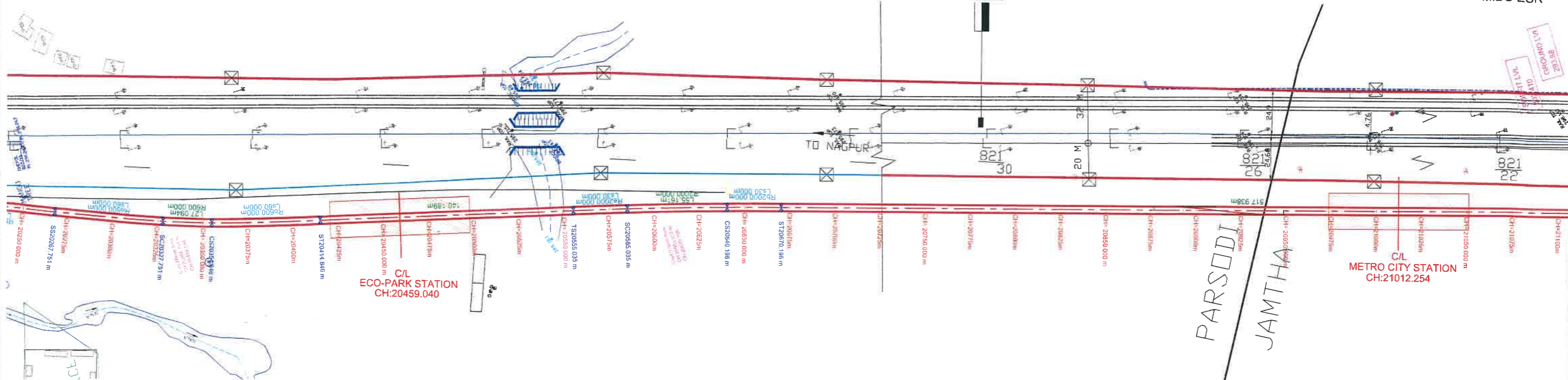

- SPECIAL NOTES:**
- BEFORE EXECUTION OF WORK, THE ENGINEER IN-CHARGE SHALL CHECK ALL THE LEVELS, COORDINATES, ETC.
 - CHAINAGES AND LAYOUT OF STATIONS/PIERS/PLATFORMS ARE SHOWN FOR INFORMATION ONLY. FOR DETAILS SEPARATE ARCHITECTURAL/ STRUCTURAL DRAWINGS ETC SHALL BE REFERRED.
- Notes:-**
- All levels, chainages and dimensions are in meter unless otherwise mentioned.
 - Station/Pier/Platform are shown for information only.
 - The horizontal alignment, vertical profile, Rail Levels & DTM are based on the topographical survey & ground levels available with planning cell. Concern CPM and GC should re-validate the survey data at site and work shall be executed after correctness of survey is certified by concern CPM, GC & contractor.
 - Pier Arrangement shall be planned keeping C/L of pier minimum 6m away from the SR.

LEGENDS			
SYMBOL	DESCRIPTION	SYMBOL	DESCRIPTION
	METRO ALIGNMENT		RAILING
	METRO STATION BOUNDARY		COMPOUND WALL
	ASPHALT ROAD EDGE		GATE
	MEPAN (DIVIDER)		BOARD/HOARDING
	ROAD CENTER		CHAMBER
	TIE LINE		ELECTRIC POLE WITH LINE
	SHOULDER LINE		ELECTRIC DP
	RAILWAY LINE		TREE
	RAILWAY ELECTRIC POLE		FENCING



THE RESPONSIBILITY OF CONTROL, CHECK & VERIFICATION OF ACCURACY, CORRECTNESS, COMPLETENESS INTEGRATION & FULL COMPLIANCE OF CONTRACT PROVISIONS IN RESPECT OF DESIGN ANALYSIS & DRAWINGS RESTS WITH THE DESIGN CONSULTANT AND CONTRACTOR			
Maha Metro	For GAD Approval	Signature	Maha Metro
Approved			Approved
	ED (Reach-1A & Truck)		ED (Electrical)
	GM (Design)		ED (Signaling)
	Sr. DGM (Planning-I)		ED (Rolling Stock)
	ED (Planning-I & Land)		GM (O&M)

GOOD FOR CONSTRUCTION

MAHARASHTRA METRO RAIL CORP. LTD.

METRO BHAVAN, INFRONT OF DR. BABASAHEB AMBEDKAR COLLEGE, DEEKSHABHOOMI, NAGPUR-440010

TITLE: ALIGNMENT PLAN & VERTICAL PROFILE FOR AT-GRADE SECTION OF REACH 1A FROM TAKE-OFF POINT (CH:19550) UPTO METRO CITY STATION

HORIZONTAL SCALE: 1:1000 (0 to 100m)

VERTICAL SCALE: 1:100 (0 to 50m)

DRG.NO. MM/PLG-I/1A/AG/AGAD/2023/R3 **REV.** 03 **PAPER SIZE** A1 **DATE** 16.01.2024 **SHEET NO.** 02 OF 03

